

The Running Magnet 2.0 Surface

High-tech LED lighting system for interior architecture.

Light Shadow Spot 30

LED accent lighting module for installation in The Running Magnet system. For wireless control of luminaires, please select Casambi integrated versions. Accessories available, (honeycomb and CCT dichroic filters).

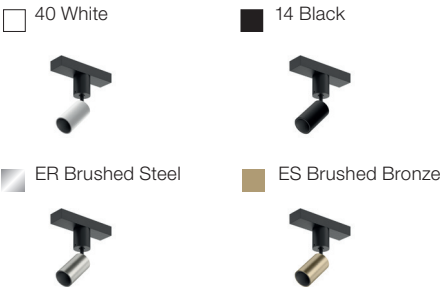
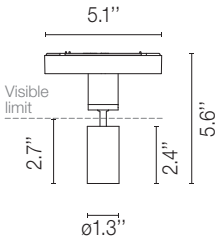

How to Specify ex. 05.9100.EQ

CCT	CRI	Initial Lumens	Delivered Lumens	Part Number	Finish	Beam Angle	Watts	Dimming Protocol
2700K	90	257 lm	209 lm	05.9100	<div><div></div> 40 White</div> <div><div></div> 14 Black</div> <div><div></div> ER Brushed Steel</div> <div><div></div> ES Brushed Bronze</div>	10	4W	<div><div></div> On Board Dimmer</div> <div><div></div> DA = Dali 2</div> <div><div></div> 1V = 1-10V</div> <div><div></div> CB = Casambi Integrated</div>
2700K	90		201 lm	05.9101		22		
2700K	90		200 lm	05.9102		33		
2700K	90		209 lm	05.9103		46		
3000K	90	263 lm	214 lm	05.9105	<div><div></div> 40 White</div> <div><div></div> 14 Black</div> <div><div></div> ER Brushed Steel</div> <div><div></div> ES Brushed Bronze</div>	10	4W	<div><div></div> On Board Dimmer</div> <div><div></div> DA = Dali 2</div> <div><div></div> 1V = 1-10V</div> <div><div></div> CB = Casambi Integrated</div>
3000K	90		205 lm	05.9106		22		
3000K	90		204 lm	05.9107		33		
3000K	90		214 lm	05.9108		46		

The Running Magnet 2.0 Surface

High-tech LED lighting system for interior architecture.

Photometrics

2700K

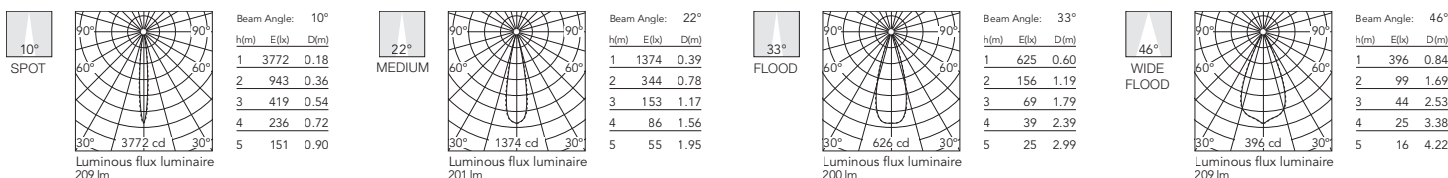

3000K

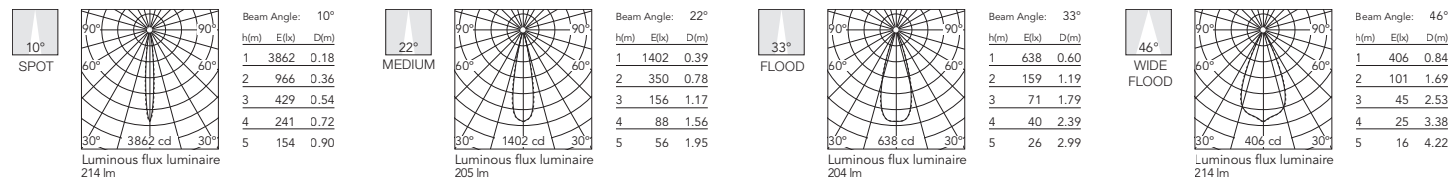

Optional Accessories

Honeycomb	CCT Increaser Filter D58	CCT Decreaser Filter D12
	2700K >> 3125±75K 3000K >> 3600±75K	2700K >> 2450±75K 3000K >> 2700±75K
Part Number: 08.0790.00	Part Number: 08.0791.00	Part Number: 08.0792.00
		